

**TYPICAL CROSS SECTION OF STORM WATER DRAINAGE CANAL**

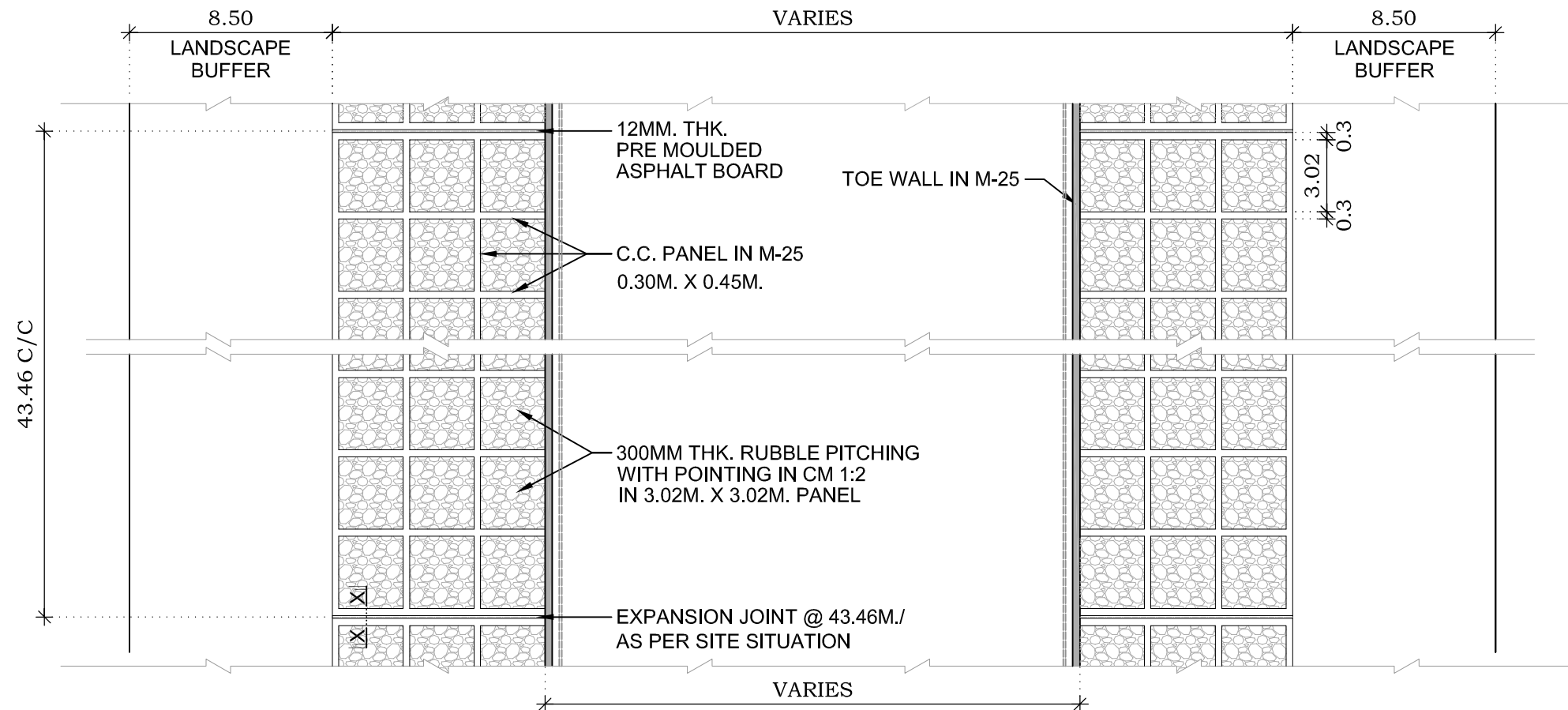

**TYPICAL PLAN OF PANEL PITCHING**

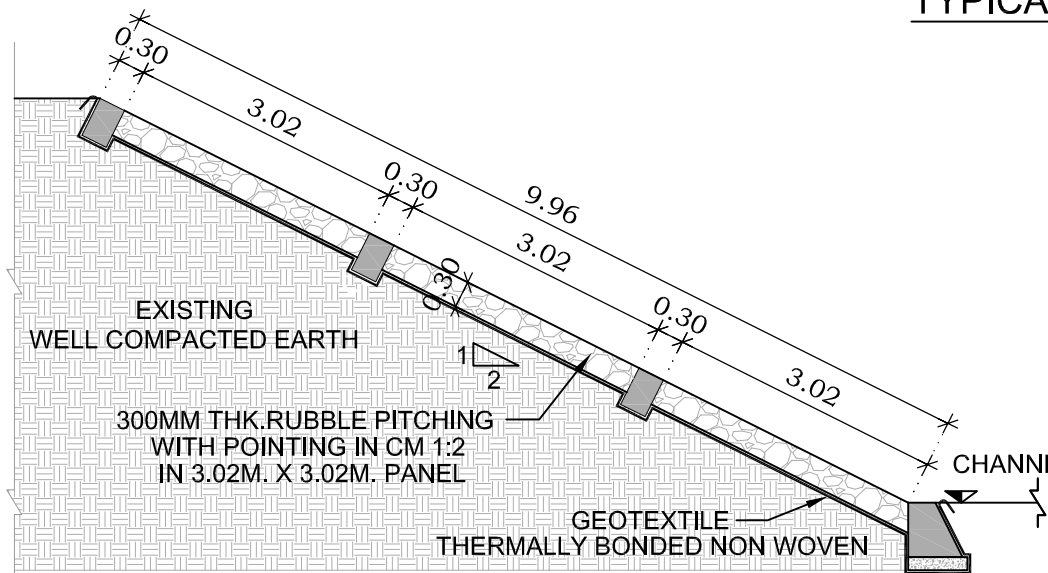

**TYPICAL DETAILS OF STONE PANEL PITCHING**

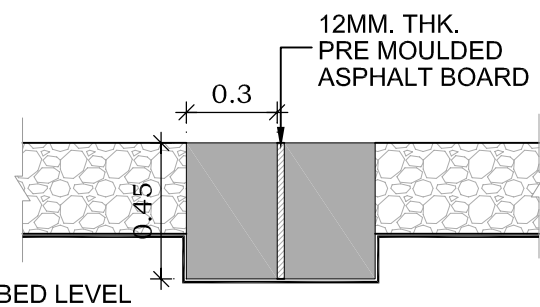

**SECTION 'X-X'  
DETAILS AT EXPANSION JOINT**

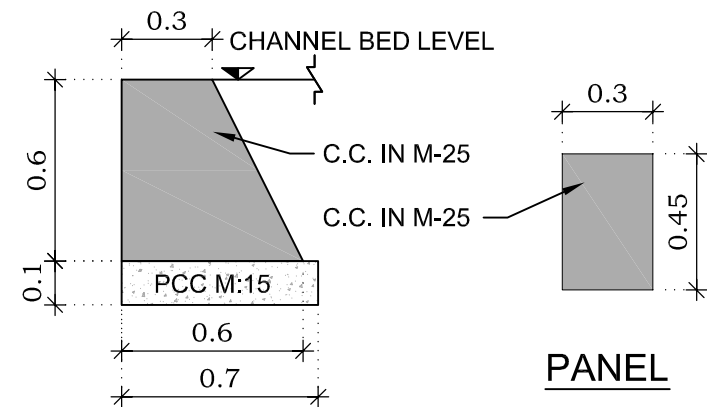

**TOE WALL**

**PANEL**

**DETAILS OF CANAL**

CHAINAGE		BOTTOM WIDTH (B1) (m)	TOP WIDTH (B2) (m)	TOP WIDTH WITH BUFFER (m)
FROM	TO			
0+000	0+555	58.7	76.5	93.5
0+610	1+292	73.7	91.5	108.5
1+322	1+849	83.7	101.5	118.5
1+861	2+622	83.7	101.5	118.5
2+652	2+811	88.7	106.5	123.5
2+888	5+720	88.7	106.5	123.5

REV.	Date	Revision Description	Checked	Approved
------	------	----------------------	---------	----------

PURPOSE :

☐ DPR ☒ TENDER ☐ CONSTRUCTION

CLIENT : **DICDL** DHOLERA INDUSTRIAL CITY DEVELOPMENT LIMITED

CONSULTANT : **Multi Media Consultants Pvt. Ltd.**  
" Multi House ", Lane Next to C.N. Vidhyalaya,  
Bh. Reliance Petrol Pump, Ambawadi, Ahmedabad - 380 006.  
in JV with

**DHI** **DHI (India) Water & Environment Pvt. Ltd.**  
3rd Floor, NSIC - STP Complex, NSIC Bhavan,  
Okhla Industrial Estate, New Delhi - 110 020

PROGRAMME MANAGER : **AECOM** AECOM ASIA COMPANY LTD.

PROJECT : ENHANCEMENT OF SIDE SLOPE OF STORM WATER DRAINAGE CANAL IN ACTIVATION AREA IN DHOLERA SPECIAL INVESTMENT REGION.

PROJECT CODE 029-04-1-19-001

TITLE : TYPICAL DETAILS OF PANEL PITCHING FOR STORM WATER CANAL

Drawn By: VIJAY GAJERA Reviewed: J. B. PATEL

Checked: A. N. P. Approved: A. N. P.

Scale: N.T.S. REV.: R0

Project Drawing No: DICDL/SWC/TYPCS-01 Sheet: 01 of 01